

STELLAR 1425

NINTH FLOOR PLAN

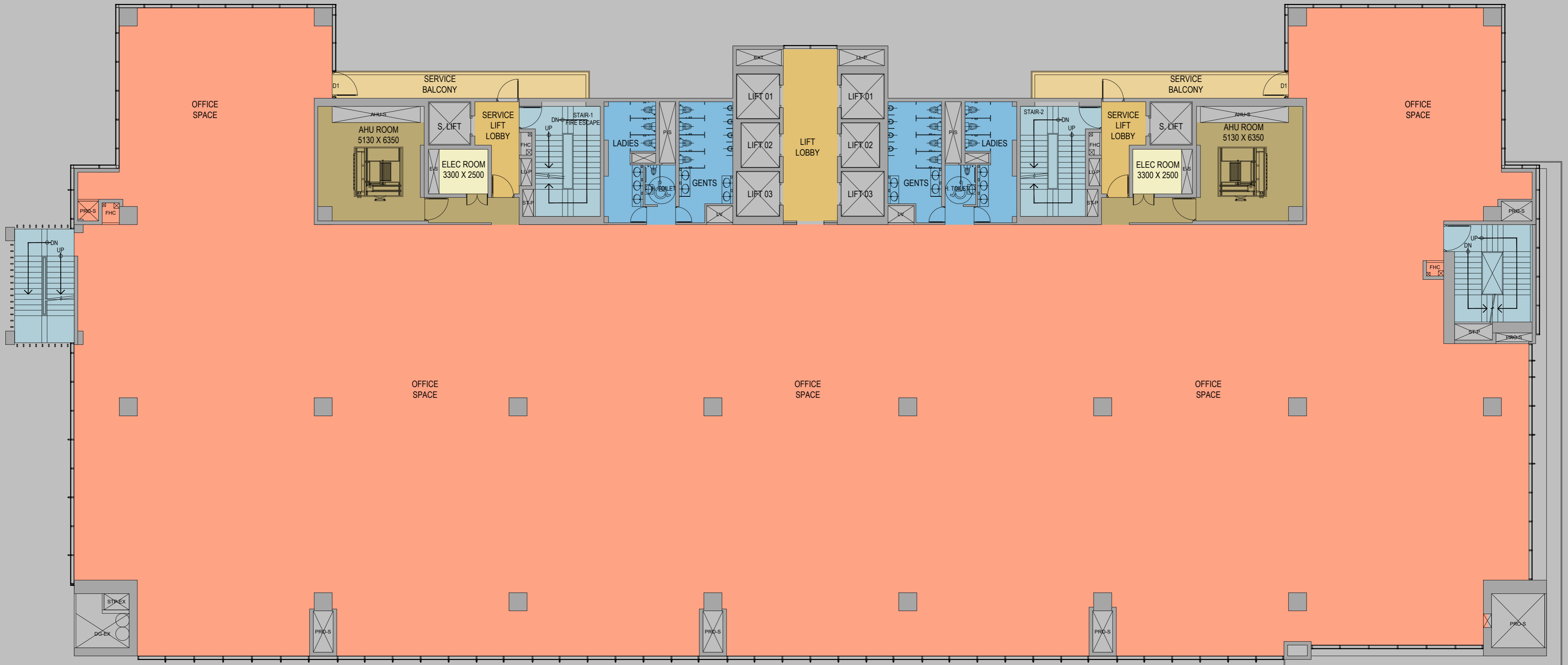

Carpet Area: 2387.47 sq.m.(25,698.72 sq.ft.)
Leasable Area: 34,264.96 sq.ft.
Efficiency: 75%

ADD: PLOT NO. - 5, SECTOR-142, NOIDA - 201301(UP)

ORIENTATION: